



Spare Parts Lists

Sweeper KM 50

KM 13050 M-ABR 50 / KM 13050 H-ABR 50
KM 14750 M-ABR 50 / KM 14750 H-ABR 50
KM 16550 M-ABR 50 / KM 16550 H-ABR 50
KM 19050 M-ABR 50 / KM 19050 H-ABR 50
KM 22550 M-ABR 50 / KM 22550 H-ABR 50

Roll diameter 50 cm
for municipal tractors. Carrier vehicles from 18 kW



Order number: from Machine No: Rev.: R01 Date: 07.2006



Manufactures by
Kersten Arealmaschinen GmbH
Empeler Straße 95
D - 46459 Rees
www.kersten-maschinen.de



Distributed in UK by
Kersten (UK) Ltd Tel. 0118 986 9253
Progrees House 39 Boulton Road
Reading, RG2 0NH
www.kerstenuk.com - info@kerstenuk.com

Contents

1. BASIC UNIT FKM 1300-2250 MECHANICALLY POWERED	Date: 07.06	3
2. BASIC UNIT FKM 1300H-2250H (with hydraulic drive and control valve)	Date: 08.06	6
3. DIRT CONTAINER, CULTIVATED SIDE (hydraulic, continuous)		9
For FKM 1300- 2250	Date: 07.06	9

1. Basic unit FKM 1300-2250 mechanically driven

Date: 07.06

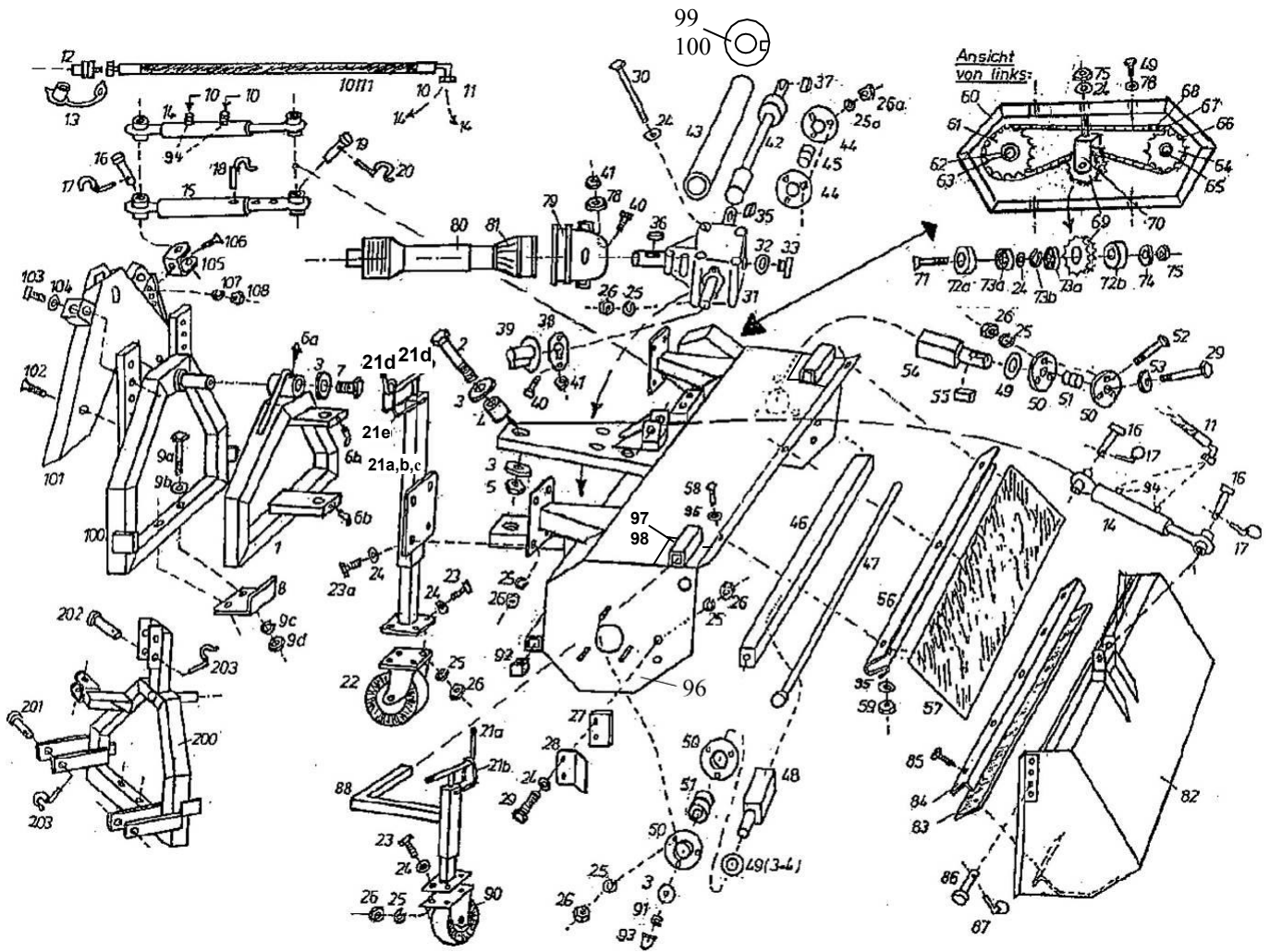

Basic unit FKM 1300-2250 mechanically driven Pos.1-47

Date: 09.04.08

No.	Order no.	Nu	Description
1	130 000 010	1	Mounting frame, front
2	901 116 070	2	Screw
3	905 216 000	6	Diameter washer
4	705 301 744	2	Rifle
5	900 016 002	2	Stop mother
6a	910 006 000	1	Grease nipple
6b	910 006 045	2	Grease nipple 45 °
7	901 016 020	1	Screw
8	130 000 045	1	Backstop
9a	901 112 090	2	Dcrew
9b	905 112 000	2	Washer
9c	905 012 000	2	Spring washer
9d	900 012 001	2	Mother
Variant 1 with dome triangle - * :			
100	130 ... 001*	1	Intermediate frame
101	130 ... 002*	1	Mounting frame, rear
102	901 212 010	2	Senkschraube
103	901 012 020	2	Screw
104	905 112 000	2	Washer
105	127 ... 003*	1	U-iron
106	901 210 030	2	Senkschraube
107	905 010 000	1	Spring washer
108	900 010 001	1	Mother
109	907 400 073	1	Bolt 19mm
110	907 111 000	1	Linch pin
Variant 2 with three-point suspension - * :			
200	130 ... 005*	1	Mounting frame, 3-point
201	907 400 051	2	Bolt 22 mm
202	907 400 073	1	Bolt 19 mm
203	907 111 000	3	Linch pin
10	930*	0-2	Tube
11	930*	2	Swing cylinders
12	932 1.. ..*	2-4	Tube
13	932 3.. ..*	2-4	Aushebezylder
14	933 101 180	1-2	Hydraulic connector
15	050 300 010	0-1	Dust cap
Pos. 15 + 18 instead of oos.14 Swing cylinders			
16	907 400 073	3	Top link pin
17	907 111 000	2	Linch pin
18	907 190 950	1	Pipe linch pin
19	907 400 073	1	Top link pin
20	907 111 000	1	Linch pin
21a	C05418	1	Support on the right
21b	C05417	1	Support left
21c	C05419	2	Support inner part
21d	942 003 003	8	Protective cap
21e	942 003 002	4	Clip
22	926 304 200	2	Steering block pulley Ø 200
23	901 010 020	16	Screw

No.	Order no.	Nu	Description
23a	901 010 025	8	Screw
24	905 110 000	32	Washer
25	905 010 000	32	Spring washer
26	900 010 001	32	Mother
25a	905 008 000	9	Spring washer
26a	900 008 001	9	Mother
27	130 000 015	2	Flat iron
28	130 000 016	2	Tank attack
29	901 010 030	4	Screw
30	901 010 120	4	Screw
31	922 101 000	1	Bevel gear
32	937 120 025	1	Sealing ring
33	931 000 031	1	Oil filler plug
34	924 425 477	1	Shaft seal without picture
35	908 008 725	1	Adjusting spring
36	908 008 730	1	Adjusting spring
37	908 008 720	1	Adjusting spring
38	C02219	1	Cover plate for
39	943 400 038	1	Transmission
40	901 006 020	8	Cover yellow
41	900 006 002	4	Screw
Drive shaft:			
42a	130 000 100	1	FKM 1300
42b	147 000 100	1	FKM 1475
42c	165 000 100	1	FKM 1650
42d	190 000 100	1	FKM 1900
42e	225 000 100	1	FKM 2250
Shroud:			
43a	130 000 105	1	FKM 1300
43b	147 000 105	1	FKM 1475
43c	165 000 105	1	FKM 1650
43d	190 000 105	1	FKM 1900
43e	225 000 105	1	FKM 2250
44	924 200 205	2	Bearing shell
45	924 100 205	1	Camp
Drive tube:			
46a	130 000 440	1	FKM 1300
46b	147 000 440	1	FKM 1475
46c	165 000 440	1	FKM 1650
46d	190 000 440	1	FKM 1900
46e	225 000 440	1	FKM 2250
Tension rod:			
47a	130 000 435	1	FKM 1300
47b	147 000 435	1	FKM 1475
47c	165 000 435	1	FKM 1650
47d	190 000 435	1	FKM 1900
47e	225 000 435	1	FKM 2250

Note: sign - * = necessarily
Specify tractor type

Basic unit FKM 1300-2250 mechanically driven Pos. 48- 95

Date: 21.07.06

No.	Order.	Nu	Description
48	130 000 351	1	Drive stub,
49	705 631 305	4-5	Right
50	924 200 207	4	Disc
51	924 100 207	2	Bearing shell
52	901 910 020	3	Camp
53	905 210 000	1-2	Carriage bolt
54	130 000 346	1	Disc
55	908 181 030	1	Drive stub, left
56a	130 000 590	1	Adjusting spring
56b	147 000 590	1	Retaining rail:
56c	165 000 590	1	FKM 1300
56d	190 000 590	1	FKM 1475
56e	225 000 590	1	FKM 1650
57a	130 000 585	1	FKM 1900
57b	147 000 585	1	FKM 2250
57c	165 000 585	1	Rubber injection flaps: FKM 1300
57d	190 000 585	1	FKM 1475
57e	225 000 585	1	FKM 1650
58	901 006 020	nB	FKM 1900
59	900 006 002	nB	FKM 2250
60	130 000 165	1	Screw (nB =
61	C03840	1	upon need)
62	905 209 283	1	Stop mother
63	901 008 016	1	Transmission cover
64	920 402 114	1	Sprocket, big - 26
65	906 000 250	1	Teeth
66	920 102 930	1	Diameter washer
For speed increase pos. 66 and 61 change			
61a	920 402 322	1	Sprocket, big - 22 teeth for
66a	920 102 905	1	Speed increase
67	920 202 000	1	Chain
68	920 302 000	1	Half chain link
69	920 402 215	1	Chain lock
70	130 000 270	1	Tensioning wheel
71	901 210 070	1	Headband
72a	705 205 011	1	Senkschraube
72b	705 205 013	1	Bush, 20 Ø 11
73a	924 106 200	2	mm
73b	906 000 390	1	Bush, 20 Ø 13.5 mm
69-73	130 000 180	1	Camp

No.	Order.	Nu	Description
74	905 210 000	1	Diameter washer
75	900 010 002	2	Stop mother
78	905 206 000	6	Diameter washer
79	923 003 001	1	Protective pot on the gearbox
80	923 3...0 *	1	Propeller shaft
81	923 3...1 *	1	Complete with protection
82a	130 000 625	1	Clippings:FKM 1300
82b	147 000 625	1	FKM 1475
82c	165 000 625	1	FKM 1650
82d	190 000 625	1	FKM 1900
82e	225 000 625	1	FKM 2250
83a	130 000 630	1	Rubber splash flap: FKM 1300
83b	147 000 630	1	FKM 1475
83c	165 000 630	1	FKM 1650
83d	190 000 630	1	FKM 1900
83e	225 000 630	1	FKM 2250
84a	130 000 635	1	Angle rail FKM 1300
84b	147 000 635	1	FKM 1475
84c	165 000 635	1	FKM 1650
84d	190 000 635	1	FKM 1900
84e	225 000 635	1	FKM 2250
85	902 642 013	5	Tapping screw
86	C00171	2	Bolt with ring
87	907 106 000	2	Linch pin
88	127 000 020	1	Parking support, right
89	127 000 021	1	Parking support, left
90	926 301 125	2	Caster
91	905 016 000	1	Spring washer
92	943 140 402	2	Cover cap tube
93	943 559 012	1	Cap
94	937 302 540	2-4	Tension rod
95	905 106 000	nB	Seal kit for
96a	C03525	1	Headers mech. KM 13050 M
96b	C03526	1	KM 14750 M
96c	C03527	1	KM 16550 M
96d	C03528	1	KM 19050 M
96e	C03529	1	KM 22550 M
97	C01126	2	Holder parking support
98	C01127	2	counterplate
99	C06089	1	Holder f. Drive shaft protection
100	902 604 012	1	tapping screw

**Note: sing - * =
Necessarily indicate tractor type**

2. Basic unit FKM 1300H-2250H (with hydr. Drive and control valve) Date: 08.06

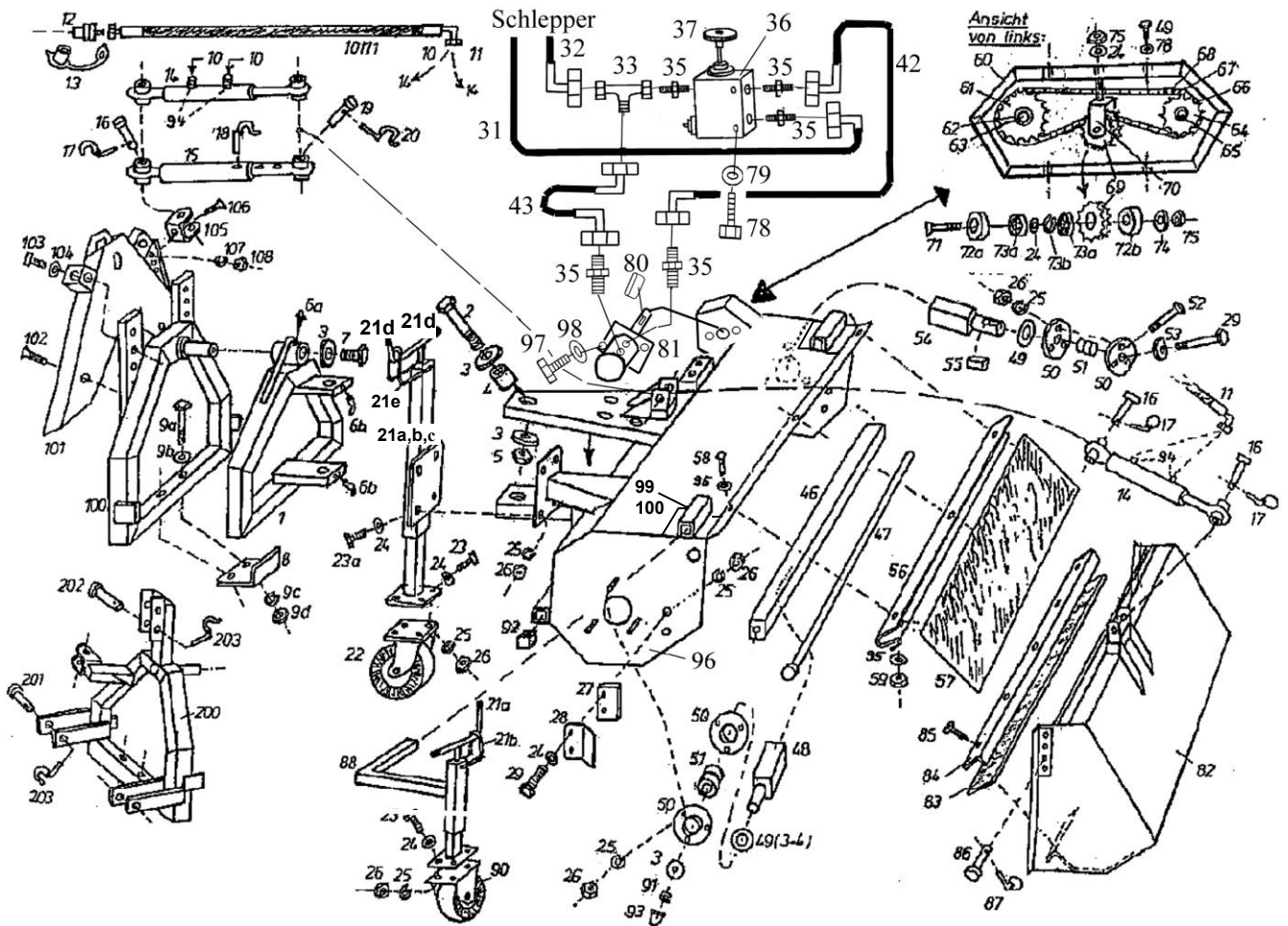

Basic unit FKM 1300H-2250H (with hydraulic frive and control valve) Date: 09.04.08

No.	Order no.	Nu	Description
1	130 000 010	1	Mounting frame, front
2	901 116 070	2	Screw
3	905 216 000	6	Diameter washer
4	705 301 744	2	Rifle
5	900 016 002	2	Stop mother
6a	910 006 000	1	Grease nipple
6b	910 006 045	2	Grease nipple 45 °
7	901 016 020	1	Screw
8	130 000 045	1	Backstop
9a	901 112 090	2	Screw
9b	905 112 000	2	Washer
9c	905 012 000	2	Spring washer
9d	900 012 001	2	Mother
Variante 1 with dome triangle - * :			
100	130 ... 001*	1	Intermediate frame
101	130 ... 002*	1	Mounting frame, rear
102	901 212 010	2	Lowering screw
103	901 012 020	2	Screw
104	905 112 000	2	Washer
105	127 ... 003*	1	U-iron
106	901 210 030	2	Lowering screw
107	905 010 000	1	Spring washer
108	900 010 001	1	Mother
109	907 400 073	1	Bolt 19mm
110	907 111 000	1	Linch pin
Variante 2 with three-pint suspension - * :			
200	130 ... 005*	1	Mounting frame,
201	907 400 051	2	3-point
202	907 400 073	1	Bolt 22 mm
203	907 111 000	3	Bolt 19 mm
10	930*	0-2	Linch pin
11	930*	2	Hydraulic hose
12	932 1.. ...*	2-4	Swing cylinders
13	932 3.. ...*	2-4	Hydraulic hose
14	933 101 180	1-2	Lifting cylinder
15	050 300 010	0-1	Hydraulic connector
Pos. 15 + 18 instead of pos. 14 Swing cylinders			
16	907 400 073	3	Top link pin
17	907 111 000	2	Linch pin
18	907 190 950	1	Pipe linch pin
19	907 400 073	1	Top link pin
20	907 111 000	1	Linch pin
21a	C05418	1	Support on the right
21b	C05417	1	Support left
21c	C05419	2	Support inner part
21d	942 003 003	8	Protective cap
21e	942 003 002	4	Clip
22	926 304 200	2	Steering block pulley Ø
23	901 010 020	16	200

No.	Order no.	Nu	Description
23a	901 010 025	8	Screw
24	905 110 000	32	Washer
25	905 010 000	32	Spring washer
26	900 010 001	32	Mother
25a	905 008 000	9	Spring washer
26a	900 008 001	9	Mother
27	130 000 015	2	Flat iron
28	130 000 016	2	Tank attack
29	901 010 030	4	Screw
30	901 010 120	4	Screw
31		1	Hydraulic hose to the tractor
32		1	Hydraulic hose to the tractor
33	931 041 200	1	Hydraulikverschr.
34	924 425 477	1	Wellendichtri. without fig.
35	931 017 238	5	Hydraulikverschr.
36	936 201 000	1	Control valve
37		1	Knob
40	901 006 020	8	Screw
41	900 006 002	4	Stop mother
42	930 000 089	1	Hose Vorl. 320
43	930 000 090	1	Hose backl. 390
46a	130 000 440	1	Drive tube: FKM 1300
46b	147 000 440	1	FKM 1475
46c	165 000 440	1	FKM 1650
46d	190 000 440	1	FKM 1900
46e	225 000 440	1	FKM 2250
47a	130 000 435	1	Tension rod: FKM 1300
47b	147 000 435	1	FKM 1475
47c	165 000 435	1	FKM 1650
47d	190 000 435	1	FKM 1900
47e	225 000 435	1	FKM 2250

**Note: sign - * =necessarity
indicate tractor type**

Basic unit FKM 1300H - 2250H (Seite3)

Date: 20.08.06

No.	Order no.	Nu	Description
48	130 000 351	1	Drive stub, right
49	705 653 805	4-5	Washer
50	924 200 207	4	Bearing shell
51	924 100 207	2	Camp
52	901 910 020	3	Carriage bolt
53	905 210 000	1-2	Disc
54	130 000 346	1	Drive stub, left
55	908 181 030	1	Adjusting spring
56a	130 000 590	1	Retaining rail: FKM 1300
56b	147 000 590	1	FKM 1475
56c	165 000 590	1	FKM 1650
56d	190 000 590	1	FKM 1900
56e	225 000 590	1	FKM 2250
57a	130 000 585	1	Rubber splash flap: FKM 1300
57b	147 000 585	1	FKM 1475
57c	165 000 585	1	FKM 1650
57d	190 000 585	1	FKM 1900
57e	225 000 585	1	FKM 2250
58	901 006 020	nB	Screw (nB = as needed)
59	900 006 002	nB	Stop mother
60	130 000 135	1	transmission cover
61	C03840	1	Sprocket, big - 26 teeth
62	905 209 283	1	diameter washer
63	901 008 016	1	screw
64	920 402 214	1	Sprocket, small - 14 teeth
65	906 000 250	1	Seeger ring
66	920 102 930	1	Chain
For speed increase pos. 66 and 61 change			
61a	920 402 322	1	Sprocket, big - 22 teeth for
66a	920 102 905	1	Speed increase
67	920 202 000	1	Chain
68	920 302 000	1	Half chain link
69	920 402 015	1	chain lock
70	130 000 270	1	tensioning wheel
71	901 210 070	1	headband
72a	705 205 011	1	Sen k screw
72b	705 205 013	1	Bushing, 20 Ø 11 mm
73a	924 106 200	2	Bush, 20 Ø 13.5
73b	906 000 390	1	mm
69- 73	130 000 180	1	camp

No.	Order no.	Nu	Description
74	905 210 000	1	diameter washer
75	900 010 002	2	Stopmutter
78	901 006 045	2	screw
79	905 106 000	2	washer
80	908 008 720	1	Adjusting spring
81		1	engine
82a	130 000 625	1	Clippings: FKM 1300
82b	147 000 625	1	FKM 1475
82c	165 000 625	1	FKM 1650
82d	190 000 625	1	FKM 1900
82e	225 000 625	1	FKM 2250
83a	130 000 630	1	Rubber splash flap: FKM 1300
83b	147 000 630	1	FKM 1475
83c	165 000 630	1	FKM 1650
83d	190 000 630	1	FKM 1900
83e	225 000 630	1	FKM 2250
84a	130 000 635	1	Angle rail FKM 1300
84b	147 000 635	1	FKM 1475
84c	165 000 635	1	FKM 1650
84d	190 000 635	1	FKM 1900
84e	225 000 635	1	FKM 2250
85	902 642 013	5	Tapping screw
86	800 000 036	2	Round pins
87	907 106 000	2	Linch pin
88	127 000 020	1	Parking support, right
89	127 000 021	1	Parking support, left
90	926 307 125	2	Caster
91	905 016 000	1	Spring washer
92	943 140 402	2	Cover cap tube
93	943 559 012	1	Cover cap Tension rod
94	937 302 540	2-4	Seal kit for
95	905 106 000	nB	Wacher (nb = as needed)
96a	C03532	1	Basic housing hydr. KM 13050 H
96b	C03533	1	KM 14750 H
96c	C03534	1	KM 16550 H
96d	C03535	1	KM 19050 H
96 e	C03536	1	KM 22550 H
97	901 012 040	2	Screw
98	905 112 000	4	Washer
99	C01126	2	Holder storage
100	C01127	2	Counterplate

**Note: sign - * =
necessarity indicate tractor type**

Dirt collecting, mounted side brush (hydraulic, steplessly adjustable) for FKM 1300- 2250

Date: 07.06

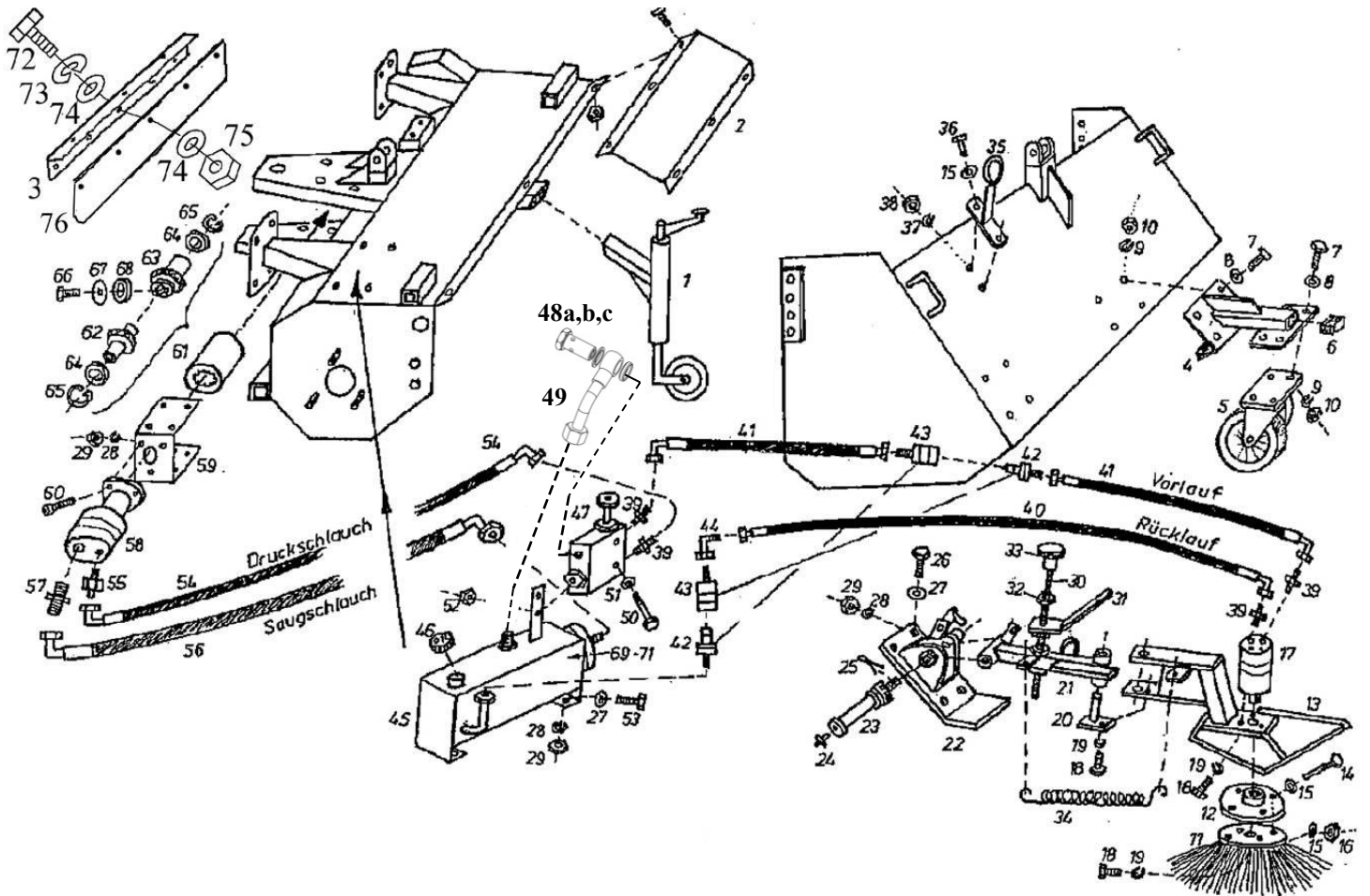

Dirt collecting container, mounted side brush for FKM 1300- 2250

Date: 07.06

No.	Order no.	Nu	Description	No.	Order no.	Nu	Description
1	130 600 000	1	Deputy support wheel	37	905 008 000	2	Spring washer
2a	5 1300 255	1	Apron: FKM 1300	38	900 008 001	2	Mother
				39	931 071 238	4	Hydraulic kverraubg
2b	5 1475 255	1	FKM 1475	40	930 000 018	1	Hydraulic hose
2c	5 1650 255	1	FKM 1650	41	930 001 022	2	Hydraulic hose
2d	5 1900 255	1	FKM 1900	42	932 161 323	2	Hydraulic plug
2e	5 2250 255	1	FKM 2250	43	932 231 223	2	Hydraulic sleeve
3a	130 000 635	1	Angle machine: FKM 1300	44	931 061 200	1	Hydraulic fitting
3b	147 000 635	1	FKM 1475	45	127 000 111	1	Tank for side brush
3c	165 000 635		FKM 1650				
3d	190 000 635		FKM 1900				
3e	225 000 635		FKM 2250	46	931 200 031	1	Oil filler plug
4	127 000 110	1	Holder impeller on	47	936 201 000	1	Control valve
5	926 303 160	1	Wheel	47a	936 202 075	1	Control cartridge
6	943 160 403	1	Plastic cap	48a	931 261 038	1	Hollow screw
7	901 010 020	10	Screw	48b	937 101 038	1	Edge sealing ring
8	905 110 000	10	Washer	48c	937 117 015	1	Sealing ring Usit ring
9	905 010 000	10	Spring washer	49	931 260 002	1	Eye socket piece
10	900 010 001	10	Mother	50	901 106 045	2	Screw
11b	105 750 500	1	Flat whisk 500mmØ hart	51	905 106 000	2	Washer
				52	900 006 002	2	Stop mother
11c	105 775 500	1	Flat whisk 500mmØ mixed	53	901 010 020	4	Screw
				54	930 000 083	1	Hydraulic hose
	50% each with poly / corrugated wire trim			55	931 221 234	1	Hydraulic
12	155 000 025	1	Side cupholders				
13	127 000 745	1	Front side window	56	930 000 023	1	Hydraulic hose
14	901 108 040	4	Screw	57	931 071 534	1	Hydraulic fitting
15	905 108 000	10	washer	58	934 300 000	1	Hydraulic pump
16	900 008 002	4	Stop mother	59	130 001 725	1	Retainer for pump (new)screw
17	935 101 032	1	Hydraulic motor	60	902 210 035	3	Coupling sleeve
17a	937 301 032	1	Seal kit for engine	61	130 000 845	1	Sprocket pump side
				62	130 000 840	1	Pinion gearbox side
18	901 006 020	5	Screw	63	130 000 835	1	Thrust ring
19	905 006 000	5	Spring washer	64	130 000 850	2	Seeger ring
20	155 000 026	1	Armholder	65	906 047 000	2	Screw
21	130 000 760	1	Adjusting piece	66	901 008 016	1	Washer
22	130 000 741	1	Connecting plate	67	906 195 000	1	Spacer
23	903 220 015	1	Collar screw, 3- parts	68	705 352 504	1	Stop mother
				69	110 000 135	1	Filter carrier in the tank
24	910 010 000	1	Grease nipple	70	937 158 003	1	O-ring in the tank
25	907 250 040	1	Cotter	71	937 200 010	1	Filter in the tank
26	901 010 025	4	Screw	72	901 008 016	5	screw
27	905 110 000	8	Washer	73	905 008 000	5	spring washer
28	905 010 000	11	Spring washer	74	905 108 000	10	washer
29	900 010 001	11	Mother	75	900 008 001	5	mother
31	155 000 027	1	Rotary lever for locker.	76a	130 000 586	1	Rubber splash flap: FKM 1300
32	155 000 023	1	Spindle				
33	941 410 031	1	Handwheel, complete	76b	147 000 586	1	FKM 1475
34	909 200 155	1	Mainspring	76c	165 000 586		FKM 1650
35	127 000 113	1	Hydraulic hose holder	76d	190 000 586		FKM 1900
36	901 008 020	2	Screw	76e	225 000 586		FKM 2250

Kersten

SITE MAINTENANCE EQUIPMENT

Distributed in UK by
Kersten (UK) Ltd Tel. 0118 986 9253

Progress House
39 Boulton Road Reading, RG2 0NH
www.kerstenuk.com - info@kerstenuk.com